

## Directions

- I-75 to I-675 North, exit at Route 48 South (4A)
- Left onto Alex-Bell Pike
- Left onto Paragon Road

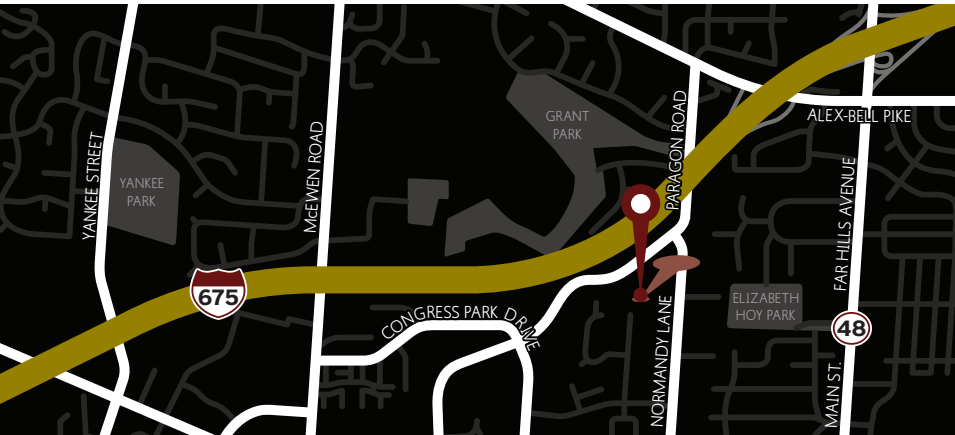

## Apartment Features

- Private exterior entry
- Large entry foyer
- "See-thru" apartments have lots of windows for a breezeway effect
- Cathedral ceiling\*
- Woodburning fireplace\*
- Built-in bookcase\*
- Open bar area between kitchen and dining room
- Modern, fully equipped, all white kitchen
- Private covered deck/large patio
- Washer/dryer connections
- Mini-blinds
- Additional bulk storage\*
- Ceramic tile tub surround

## Community Features

- Free-form swimming pool
- Jacuzzi
- Lighted tennis court

## Private Clubhouse Features

- Woodburning fireplace
- Party bar
- Large screen TV
- Party room
- 24-hour fitness center
- Tanning bed
- 24-hour laundry room
- No city taxes!

\*select apartment homes

## For further information:

7677 Tours Lane • Centerville, Ohio 45459  
NormandyClubApts.com • 937 436 3374

A Great Place to Live by Towne Properties®



# WELCOME TO NORMANDY CLUB...

A CHARMING APARTMENT COMMUNITY DEVELOPED BY TOWNE PROPERTIES SITUATED IN BEAUTIFUL WASHINGTON TOWNSHIP CONVENIENT TO INTERSTATES 675 AND 75 AND DOWNTOWN DAYTON.

Designed to fit today's active lifestyle, the Normandy Club consists of one and two bedroom apartments. The traditional French Norman style buildings are clustered around mini-cul de sacs each with a view of the beautifully landscaped grounds and lakes. The interior space features excellent closet space, natural light from ample windows and decorator kitchens.

The focal point of the Normandy Club community is the Clubhouse with its cathedral ceilings, great room, party bar and lower level exercise/work-out area. The Clubhouse overlooks the pool area with its multi-level decks and patios and the adjacent tennis court.

A blend of contemporary convenience and traditional values—Normandy Club is one of Dayton's premier apartment communities. Add to that Towne's professional management team available 24/7 to make Normandy Club truly *"A Great Place To Live®!"*

## FLOOR PLANS

01 La Maisonette  
750 sq. ft. • one bedroom, one bath

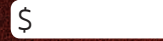

02 La Chateau  
1000 sq. ft. • two bedroom, two bath

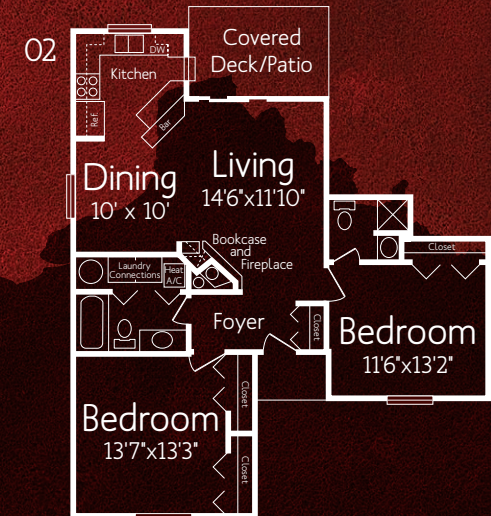

03 La Normandy  
1000 sq. ft. • two bedroom, two bath

